

DWARKA PROJECT

AREA STATEMENT

TOTAL AREA OF THE SITE 0.763 Hac.

SL.NO.	FACILITIES	PROP. AREA
1.	PRIMARY SCHOOL	4000.00 Sq.m.
	NURSARY SCHOOL	800.00 Sq.m.
	C.S.C.	1083.00 Sq.m.
	COMMUNITY ROOM	631.25 Sq.m.
	R.B.	399.36 Sq.m.
	E.S.S.	141.75 Sq.m.
	CIRCULATION	574.64 Sq.m.

NOTE

- APPROVED BY VC. DDA. ON Pg.No. 10 F8(10)/94/DWK HAF-B / PART-1 Dt. 22.10.96
- GRD. COVERAGE, F.A.R., MAX. HEIGHT AS PER M.P.D. 2001.
- THIS DRG. IS BASED ON THE FEASIBILITY REPORT SUPPLIED BY EE-WD 10 WIDE LETTER NO. WD-10/3(90)/96 DDA. 1919 DT. 6.1.97, AND SURVEY REPORT FROM DIR.(PLG.) DWARKA OFFICE.

LAY OUT PLAN

HOUSING AREA FACILITY SECTOR, 22(C)

1:500 SCALE 22(c)HAF 05/10 Drg.NO.

PLG. D M AN	<i>SP Sharma</i> PLG. ASSTT.	16.5.97 DT.
ASSTT. DIR.	JT. DIR.	DIR.

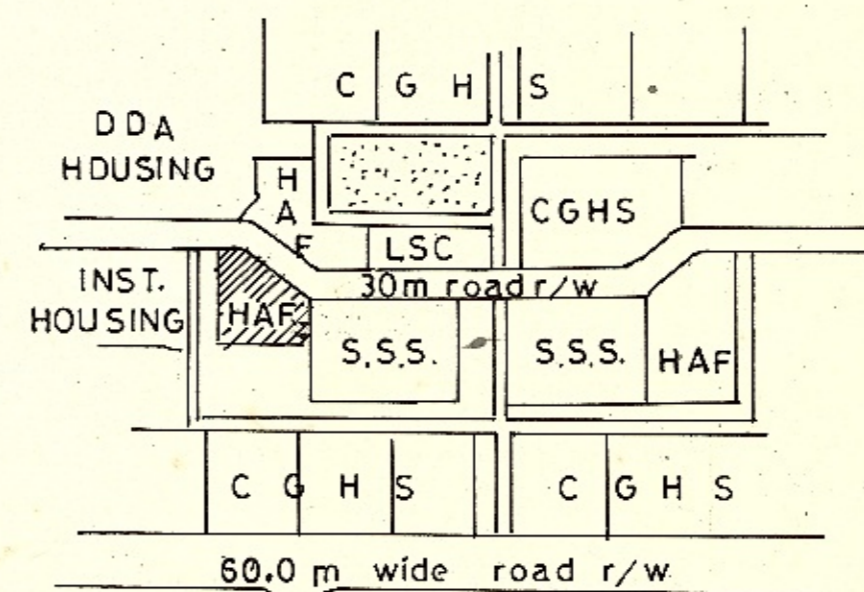

KEY PLAN

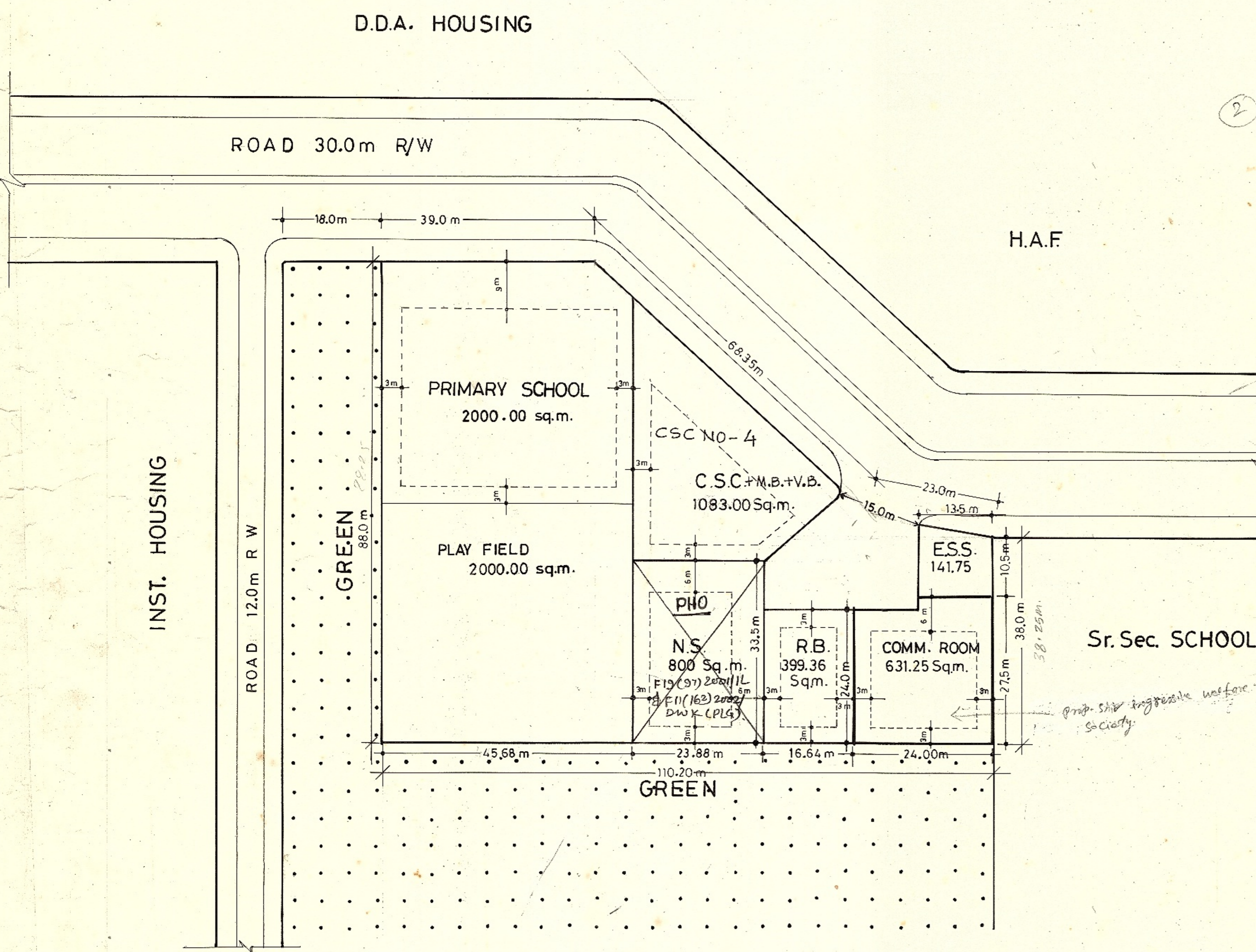

1 THE PLAN IS SUBJECT TO MODIFICATIONS WITHIN THE FRAMEWORK OF MASTER PLAN/ZONAL PLAN.
 2 IT IS FOR PLANNING PURPOSE & IS NOT FIT TO BE PRODUCED IN THE COURT OF LAW FOR PROPERTY DISPUTES.
 3 ALL THE DIMENSIONS & AREA GIVEN IN THE PLAN ARE SUBJECT TO CONFIRMATION OF OWNERSHIP/ALLOTMENT STATUS & DEMARCATIONS/FEASIBILITY REPORT FROM THE DDA LANDS & ENGINEERING WING RESPECTIVELY.

Prop. shd. be progressive work for Society.

D.D.A. HOUSING

H.A.F

Sr. Sec. SCHOOL

ROAD 30.0m R/W

ROAD 12.0m R/W

INST. HOUSING

GREEN

GREEN